

County Road 30 Construction Update

The placement of the final concrete surfacing is scheduled to begin on 6/01/18

During the placement of the concrete surfacing the access to properties along Co. Rd. 30 will be changed starting at Co. Rd. 17 and working south.

Starting on 6/01/18 please access your property from Co. Rd. 19.

Once the new, white, concrete surfacing is completed past your driveway your access will change to Co. Rd. 17.

DO NOT DRIVE ON THE NEW CONCRETE ROADWAY SURFACE.

After the concrete has been placed in front of your driveway, unless a sign tells you otherwise, you will need to turn right out of your driveway.

If a sign tells you to go left it is because to the south a turn around has not been installed and the paver will block you. Once the left only sign is taken down, turn right.

This will occur for a short timeframe, approximately one day, where portions of the shoulders will be used like an alley. After a day the direction of travel will change to a one way, with right in and right out access, accomplished with turn around areas. The turn around areas are locations where the concrete surfacing was intentionally left out to accommodate this traffic pattern. This pattern will shift with the construction as it moves towards Co. Rd. 19.

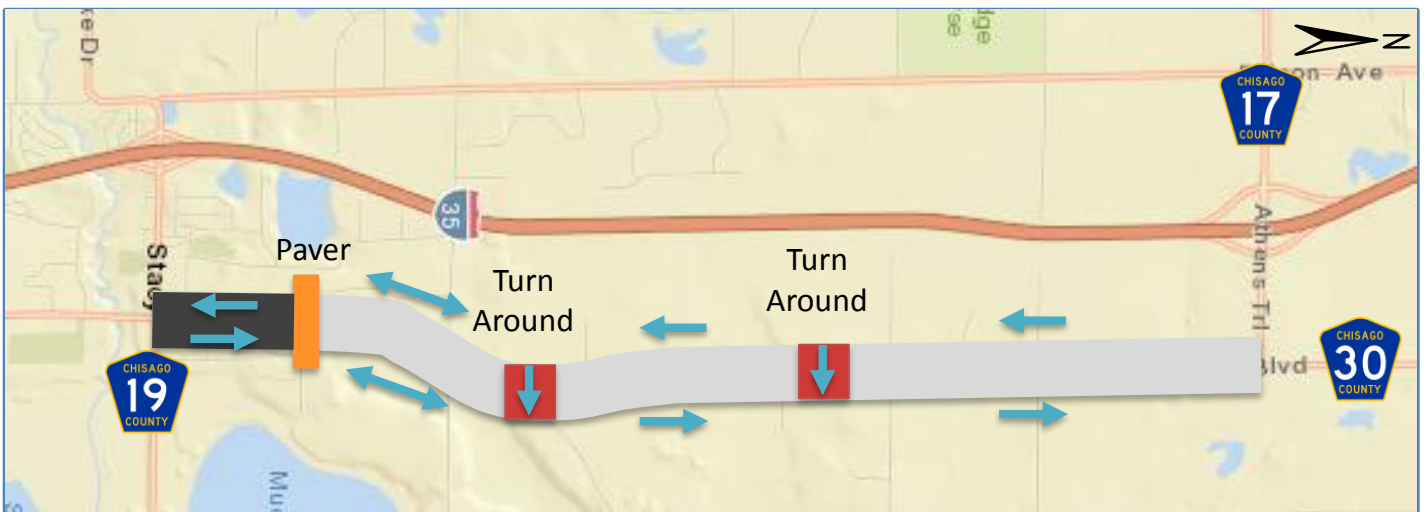
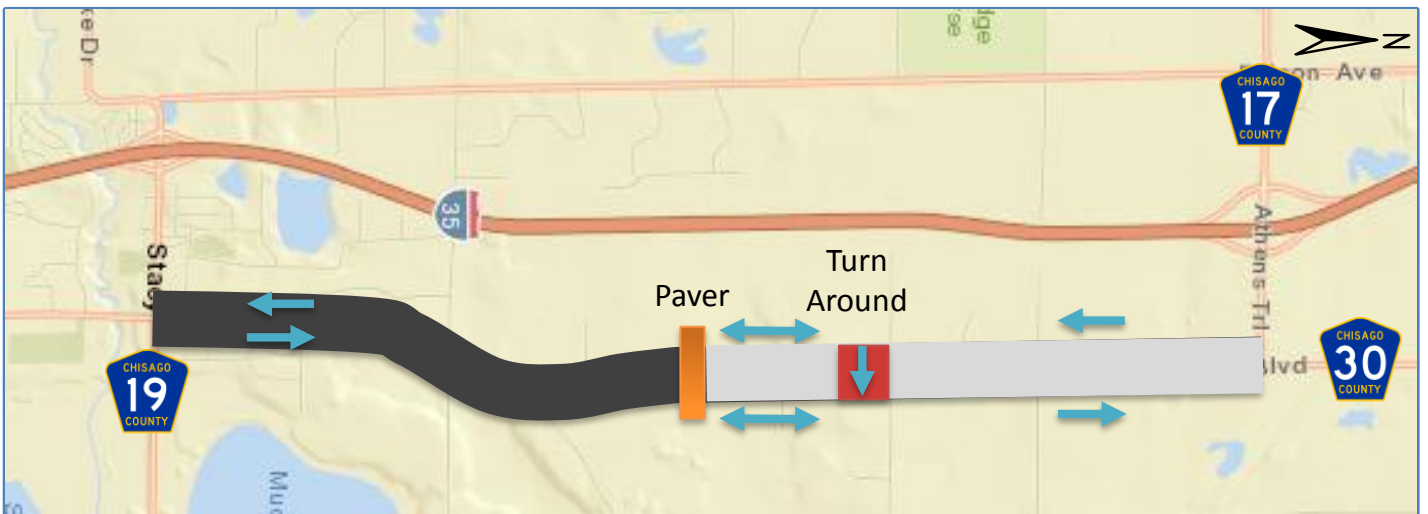
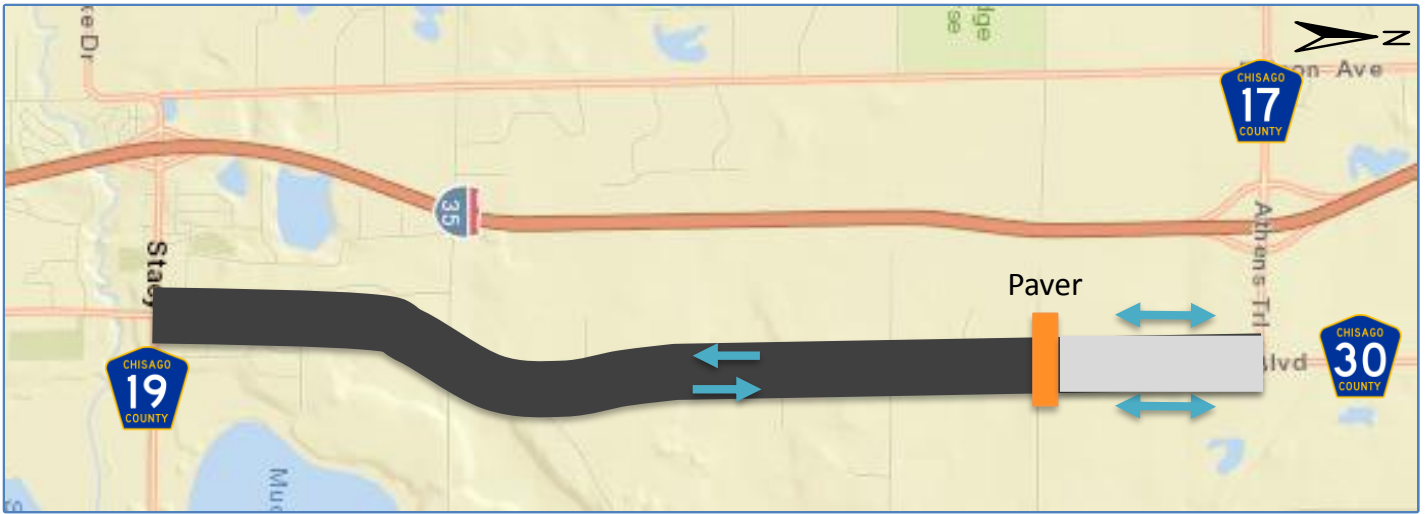

Once the placement of the surfacing is entirely completed all access will be right in right out utilizing the shoulders from either Co. Rd. 17 or Co. Rd. 19.

Please continue to remain off the new surfacing until being directed to use it. The new concrete surface needs to cure out and be sealed prior to receiving traffic.



CSAH 30 Construction
 Chisago County, Minnesota

LEGEND

-  Direction of Travel
-  Existing Roadway
-  New Concrete Surface

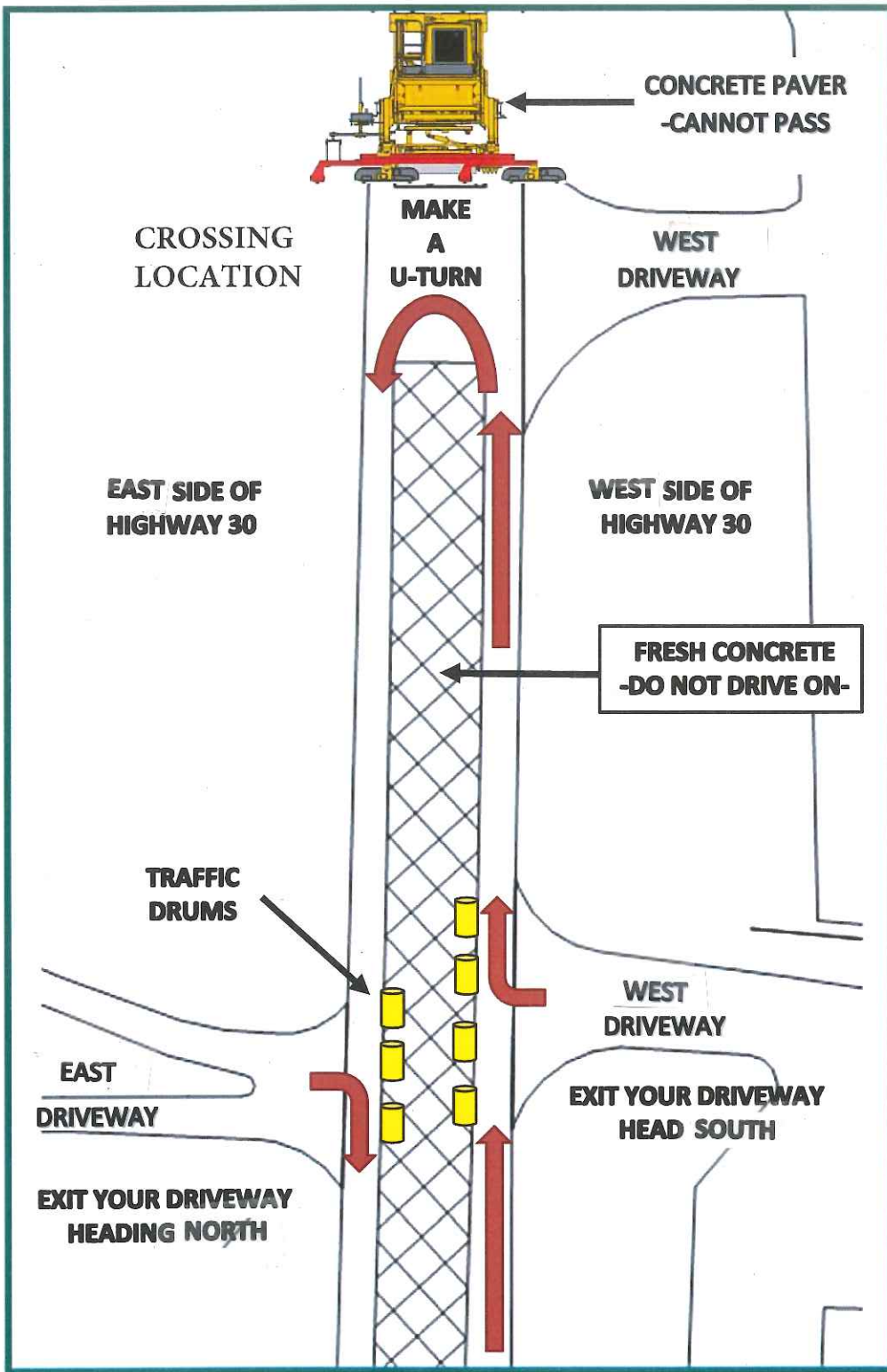

**PAVER HEADING SOUTH
TOWARD CITY OF STACY**